

DETAIL C – 3" DUCT PLUG ASSEMBLY

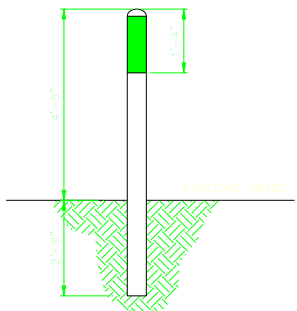

DETAIL D – FIBER ROUTE MARKER POST

USED OUTSIDE SUBSTATION YARD
TECH PRODUCTS PDM 8861

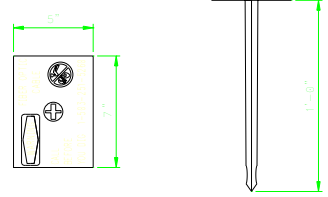

DETAIL E – GROUND MARKER

USED INSIDE SUBSTATION YARD
(NOTE 1)

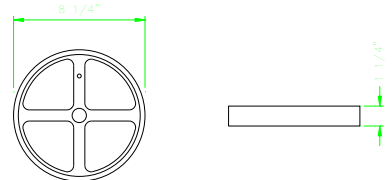

DETAIL F – ELECTRONIC MINI-MARKER

USED INSIDE/OUTSIDE SUBSTATION YARD
PACIFICORP SIF 5958476
(NOTE 2)

- NOTES:**
1. INSTALL OVER FIBER CONDUIT EVERY 15 FT. AND AT ANY BEND.
 2. INSTALL OVER FIBER CONDUIT EVERY 15 FT. AND AT ANY BEND.

COMMUNICATIONS	
PROJECT NO.	00000000
DATE	00/00/00
DESIGNED BY	00000000
CHECKED BY	00000000
APPROVED BY	00000000
SCALE	AS SHOWN
PACIFICORP	
SITE DETAILS	
FIBER OPTIC TRENCH DETAIL	
CE210002	