

| REMOVAL OF ALL FACILITIES: (SEQ 2 → SEQ 11) | |
|---|--|
| 1→2 R: #4-ACSR (PRIMARY & NEUTRAL) | 6 - R: 35' TANGENT POLE (CROSSARM) R: 25 KVA 1Ø Δ |
| 2 - R: 40' 1Ø DDE POLE (CROSSARM) R: SECONDARY DOWN GUY | 6→7 R: #4-ACSR (PRIMARY & NEUTRAL) R: OPEN-WIRE (SECONDARY) |
| 2→3 R: #4-ACSR (PRIMARY & NEUTRAL) R: OPEN-WIRE (SECONDARY) | 7 - R: 45' DEADEND POLE (CROSSARM) R: 25 KVA 1Ø Δ |
| 3 - R: 35' DDE ANGLE POLE (CROSSARM) R: ANGLE SUPPORT GUY R: 25 KVA 1Ø Δ | 7→8 R: #1/0-TX (SECONDARY) 7→9 R: OPEN-WIRE (SECONDARY) |
| 3→4 R: 4#-ACSR (PRIMARY & NEUTRAL) R: OPEN-WIRE (SECONDARY) | 8 - R: 30' SECONDARY POLE |
| 4 - R: 40' TANGENT POLE (CROSSARM) 4→5 R: SPAN GUY (SECONDARY SUPPORT) R: #4-ACSR (PRIMARY & NEUTRAL) | 9 - R: 45' SECONDARY POLE R: SECONDARY GUY |
| 5 - R: 45' TANGENT POLE (CROSSARM) R: 25 KVA 1Ø Δ 3" SER. RISER | 9 - R: 3" SECONDARY RISER |
| 5→6 R: SPAN GUY (SECONDARY SUPPORT) R: #4-ACSR (PRIMARY & NEUTRAL) | 9→54 R: #4/0-TX UG (SECONDARY) 9→11 R: #1/0-TX (SECONDARY) |
| | 11 - R: 40' SECONDARY POLE |
| | ALL OVERHEAD SERVICES BETWEEN SEQ 1 → SEQ 11 TO BE REMOVED |

| NEW INSTALLATIONS: | |
|--|--|
| 15 - I: 3" 1Ø PRIMARY RISER (ELF) | 15→20 I: #1/0 UG PRIMARY |
| 20 - I: 1Ø SECTIONALIZING ENCLOSURE | 20→30 I: #1/0 UG PRIMARY |
| 30 - I: 50 KVA 1Ø Δ | 30→32 I: #350-TX SEC. 32 - I: SEC. BOX |
| 30→32 I: #350-TX SEC. 30→34 I: #350-TX SEC. 30→40 I: #1/0 UG PRIMARY | 34 - I: SEC. BOX |
| 40 - I: 50 KVA 1Ø Δ | 40→42 I: #350-TX SEC. 42 - I: SEC. BOX |
| 40→42 I: #350-TX SEC. 40→50 I: #1/0 UG PRIMARY | |
| 50 - I: 50 KVA 1Ø Δ | 50→52 I: #350-TX SEC. 52 - I: SEC. BOX |
| 50→52 I: #350-TX SEC. 50→54 I: #350-TX SEC. | |

| NEW UNDERGROUND SERVICES: | |
|---------------------------|---------------------------|
| 30 - #1/0-TX (X2) | RELOCATE 555 & 561 METERS |
| 32 - #1/0-TX (X2) | RELOCATE 545 METER |
| 34 - #1/0-TX (X1) | RELOCATE 569 METER |
| 40 - #1/0-TX (X2) | RELOCATE 499 & 509 METERS |
| 42 - #1/0-TX (X1) | RELOCATE 519 METER |
| 52 - #1/0-TX (X1) | RELOCATE 469 METER |

51

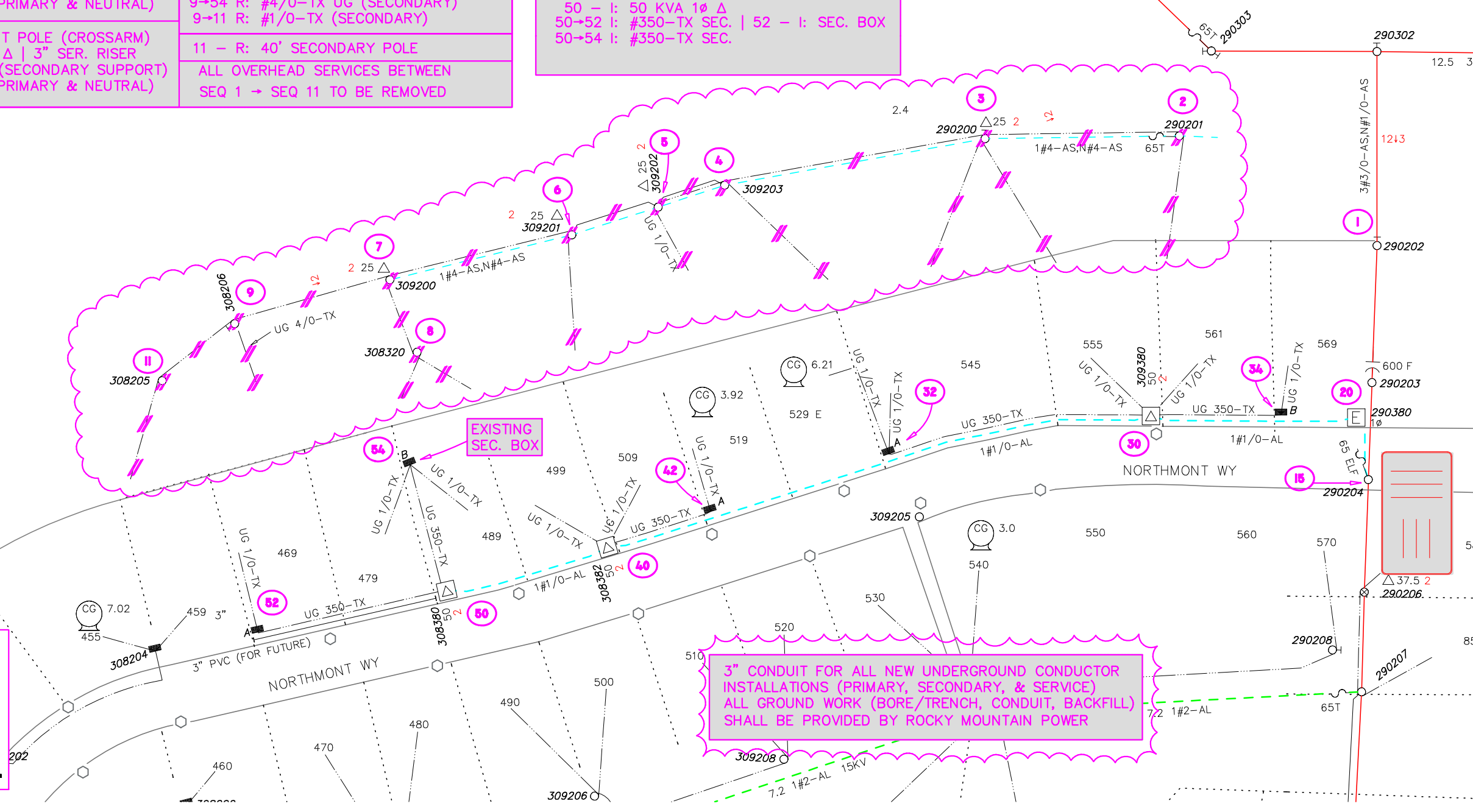

3" CONDUIT FOR ALL NEW UNDERGROUND CONDUCTOR INSTALLATIONS (PRIMARY, SECONDARY, & SERVICE)
ALL GROUND WORK (BORE/TRENCH, CONDUIT, BACKFILL) SHALL BE PROVIDED BY ROCKY MOUNTAIN POWER

PACIFICORP
A BERKSHIRE HATHAWAY ENERGY COMPANY

EST ID# 42025 | Print Date 08/27/19 | Scale 1=100'

1 OF 1

| | | |
|----------------|--|-----------------------|
| Job Start Date | Job Complete Date | Post Jobs ROLL Posted |
| Emp # | Map String 11101001.0 | Post Jobs ROLL Posted |
| CC# 11441 | WO# / REQ# 006717938 | Post Jobs ROLL Posted |
| Foreman | CUSTOMER : NBE13 NORTHMONT WAY OH TO UG 469 - 569 ADDRESS : 569 NORTHMONT WAY, SALT LAKE CITY, UT JEMAR 801-220-4569 | Post Jobs ROLL Posted |
| | E-circuit NBE13 | Post Jobs ROLL Posted |