



SALT LAKE COUNTY

Salt Lake County Public Works Department

Planning and Development Services Division

2001 S. State Street #N-3600 Salt Lake City, UT 84190-4050

Phone: 801-468-2000 FAX: 801-468-2169

http://www.pwpds.slco.org/

Salt Lake County UTAH PUBLIC SERVICE COMMISSION

VERIFICATION OF COMPLIANCE 211399

Your prompt attention to this matter is appreciated. Please return your comments to the address listed below:

SENT

11-17-09

DUE

RECEIVED 12-01-09

<p><u>Applicant Information:</u></p> <p><b>25149</b>                      <b>PERM USE</b></p> <p>3171 E 3300 S (3300 S)</p> <p>RETAIL/RESTAURANT BUILDING</p> <p>GARY GOWERS</p> <p>Parent Project Number:              25149</p>	<p><u>Office Contact:</u></p> <p>Craig Hinckley / Jerri Willden</p> <p>Chinckley@slco.org</p> <p>Phone: 468-2177 / 468-2335</p> <p>Fax: 468-2169</p>
---	--

Please review the attached request for compliance with the ordinances administered by the agency you represent and indicate whether or not it complies; any changes that would need to be made to bring it into compliance and any conditions of approval or other comments you would like the Licensing Official to consider.

- Recommend Denial: This proposal does not comply with the ordinances administered by this agency.
- Recommend Approval as Proposed: This proposal complies with the ordinances administered by this agency.
- Recommend Approval with Conditions: This business can comply if the following modifications are made and / or the following conditions of approval are implemented.

Agency: \_\_\_\_\_

Date: \_\_\_\_\_

Authorized Signature

Print

# Agency Contact List

	Department	Contact	Phone	Email
✓	Fire Department 4 copies	Stewart Gray	824-3715	<a href="mailto:sgray@ufa-slco.org">sgray@ufa-slco.org</a>
✓	Grading (4 copies) site plan elevation	Greg Baptist	468-2516	<a href="mailto:Gbaptist@slco.org">Gbaptist@slco.org</a>
✓	Salt Lake Valley Health Dept	Jeannine Maxfield	313-6700	<a href="mailto:jmaxfield@slco.org">jmaxfield@slco.org</a>
✓	Traffic Engineer	Jena Walker	468-2711	<a href="mailto:jwalker@slco.org">jwalker@slco.org</a>
✓	Urban Hydrology / Geology	John Hill Fred Lutze	468-2435 468-2431	<a href="mailto:jhill@slco.org">jhill@slco.org</a> <a href="mailto:flutze@slco.org">flutze@slco.org</a>
	Long Range Planner	Curtis Woodward	468-2074	<a href="mailto:Cwoodward@slco.org">Cwoodward@slco.org</a>
	Changes to Roads or New Roads	Max Johnson	468-3337	<a href="mailto:mrjohnson@slco.org">mrjohnson@slco.org</a>
	Building Inspector	Trent Sorensen	468-2377	<a href="mailto:tsorensen@slco.org">tsorensen@slco.org</a>
	CU Engineering & PU	Darlene Jeffreys	468-2436	<a href="mailto:APullos@slco.org">APullos@slco.org</a>
	Exception Requests	Andrea Pullos	468-3770	<a href="mailto:APullos@slco.org">APullos@slco.org</a>
	Community Council (Send for conditional uses, rezones & ordinance amendments)			
	FCOZ Planner	David Gellner	468-2360	<a href="mailto:dgellner@slco.org">dgellner@slco.org</a>
	Subdivision Planner	Todd Draper	468-2062	<a href="mailto:Ssanders@slco.org">Ssanders@slco.org</a>
✓	Engineering Review Specialist	Darlene Jeffreys	468-2436	<a href="mailto:Djeffreys@slco.org">Djeffreys@slco.org</a>
	Air Quality	Jeannine Maxfield	313-6700	<a href="mailto:jmaxfield@slco.org">jmaxfield@slco.org</a>
	Army Corps of Engineers	Hollace Jenks	295-8380 x 14	
	Flood Control	Chris Springer	468-2779	<a href="mailto:Cspringer@slco.org">Cspringer@slco.org</a>
	Forest Service – Salt Lake	Steve Scheid	801-733-2689	<a href="mailto:sscheid@fs.fed.us">sscheid@fs.fed.us</a>
	Public Works Operations (Send this any time there is construction that affects a road, including all subdivisions.)	Kevyn Smeltzer	562-6490	<a href="mailto:Ksmeltzer@slco.org">Ksmeltzer@slco.org</a>
	Parks and Recreation Planner	Angelo Calacino	468-2534	<a href="mailto:ACalacino@slco.org">ACalacino@slco.org</a>
	Post Office (for subs and multi family)	Postmaster		
	SLC Water Contracts	Karryn Greenleaf	483-6769	<a href="mailto:Karryn.Greenleaf@slcgov.com">Karryn.Greenleaf@slcgov.com</a>
	SLC Watershed Mngmt / Water Contracts	Karryn Greenleaf	483-6769	<a href="mailto:Karryn.Greenleaf@slcgov.com">Karryn.Greenleaf@slcgov.com</a>
✓	Salt Lake County Sanitation (all new construction)	Ryan Dyer	562-6419	<a href="mailto:rdyer@slco.org">rdyer@slco.org</a>
	School District (For subs and multi family)			
✓	Sewer Improvement District (all new construction)			
	Sheriff's Dept: Vice Division	Marcia	743-5892	<a href="mailto:mhedenstrom@slco.org">mhedenstrom@slco.org</a>
	State Department of Natural Resources, Division of Water Rights	Chuck Williamson	538-7240	<a href="mailto:charleswilliamson@utah.gov">charleswilliamson@utah.gov</a>
✓	UDOT	Mark Velasquez	975-4810	<a href="mailto:mvelasquez@utah.gov">mvelasquez@utah.gov</a>
	UTA		743-3882	
✓	Water District ( All New Construction)			
	Public Works / street lights	James Nell	562-6452	<a href="mailto:jnell@slco.org">jnell@slco.org</a>
✓	Public Service Commission	Julie Orchard	801- 530-6713	<a href="mailto:jorchard@utah.gov">jorchard@utah.gov</a>

Terese

Terese Curtis

Property Owner's Name: SMITHS WASATCH HOLDINGS, LLC  
 Mailing Address: 595 S RIVERWOODS PKWY., SUITE 400, LOGAN, UT 84321  
 Daytime Phone #: (801) 961-1008 City: LOGAN Zip: 84321  
 Fax #: (801) 321-0409 e-mail: MATTR@NETWASATCH.COM  
 Contact / Applicant's Name: BEECHER WALKER ARCHITECTS C/O GARY GOWERS  
 Mailing Address: 3115 E LION LN., SUITE #200  
 Daytime Phone #: (801) 438-9500 City: HOLLADAY Zip: 84121  
 Fax #: (801) 438-9501 e-mail: GARY@BEECHERWALKER.COM

To facilitate Salt Lake County's land use notice and review process, the undersigned hereby authorize the County to reproduce this application and all documents attached to the application for staff, officials, and the interested public:

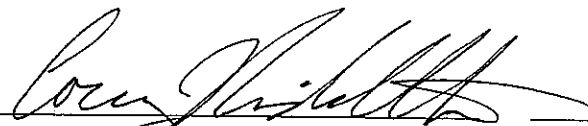
 11.9.09  
 Applicants Signature Date

Office Use Only

Application Received by: 

- Fees Due:
- \$ 300.00 Residential Non PCOZ - Four or less dwelling units
  - \$ 850.00 Residential 5 or more dwelling units \$850.00
  - \$ 1,150.00 Non-Residential - \$1,150.00

Transaction Number 190438 Cashier: Malawa Date Paid: 11/09/09



Salt Lake County Public Works Department  
 Planning and Development Services Division  
 2001 S. State Street #N-3600 Salt Lake City, UT 84190-4050  
 Phone: 801-468-2000 FAX: 801-468-2169  
<http://www.pwpds.slco.org/>

# Permitted Use

FCOZ

NON FCOZ

Date: <u>11/9/09</u>	File Number: <u>25149</u>
Community Council: <u>Canyon Rim</u>	Parent File Number:
Pre-Submittal Mtg Date (if required): <u>N/A</u>	APN: <u>16-26-407-005</u>
Pre-Meeting Location: <u>Room N3600</u>	Zone:

**Property Address:**

3171 E 3300 S.

**Requested Uses:**

Retail / Resturant

**Comments:**

**Gate key/Code:**

**Directions:**

**Standard Submittal Requirements:**  
 (Additional information may be required during the review process)  
 The items marked with an \* can be obtained from the Salt Lake County Recorder's Office 2001 South State St. Room N1600

- Affidavit Form (please use the form provided by this office)
- Legal Description of the parcel(s)
- A current parcel plat map from the recorder office. Outline the subject property with red marker.
- 16 Site Plans (4 copies if applying to the Board of Adjustment for exception requests or for signs) Drawing should be on a minimum sheet size of 18" x 24", drawn to a suitable scale (1" = 10', 1" = 20' etc.) and must include the following: North arrow, scale and drawing date. Property lines with dimensions. Adjoining streets, right-of-ways, easements etc. Location and dimensions of all existing and proposed structures and signs, please list the use and square footage of each structure. Location of structures on adjacent parcels. Location of curb, gutter and sidewalks. Parking calculations. Location of all easements.

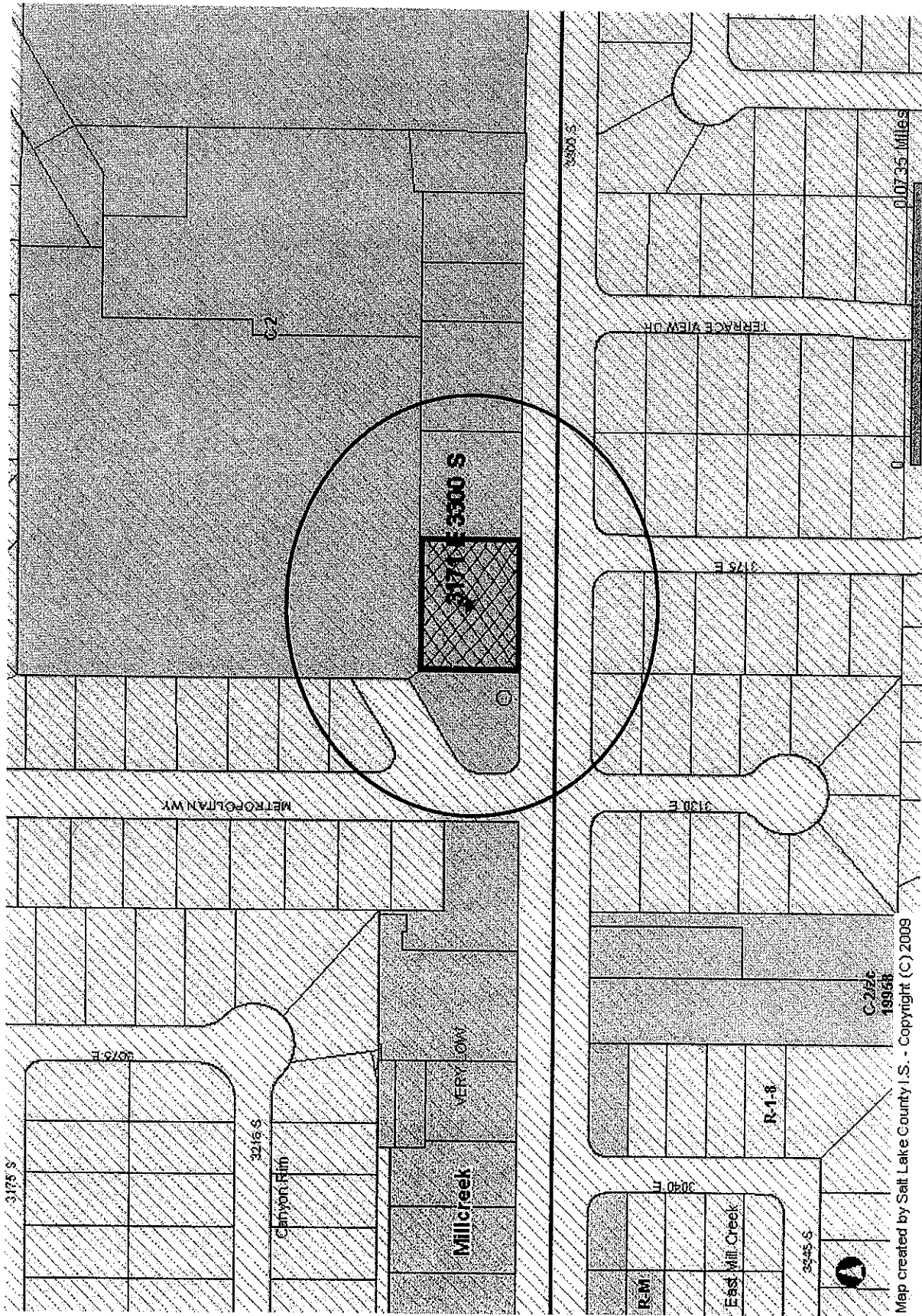

**25149 PERM USE**

3171 E 3300 S (G300 S)

RETAIL/RESTAURANT BUILDING

GARY GOWERS

Parent Project Number: 25149

<http://slcwwwgis/intra/devserv/MapFrame.htm>

11/10/2009