

Agency Contact List

	Department	Contact	Phone	Email
	Fire Department 4 copies	Stewart Gray	824-3715	sgray@ufa-slco.org
	Grading (4 copies) site plan elevation	Greg Baptist	468-2516	Gbaptist@slco.org
	Salt Lake Valley Health Dept	Jeannine Maxfield	313-6700	Jmaxfield@slco.org
X	Traffic Engineer	Jena Walker	468-2711	Jwalker@slco.org
	Urban Hydrology / Geology	John Hill Fred Lutze Andrea Pullos	468-2435 468-2431 468-3770	Jhill@slco.org flutze@slco.org APullos@slco.org
	Long Range Planner	Curtis Woodward	468-2074	Cwoodward@slco.org
	Changes to Roads or New Roads	Max Johnson	468-3337	mrjohnson@slco.org
	Building Inspector	Trent Sorensen	468-2377	tsorensen@slco.org
	CU Engineering & PU	Darlene Jeffreys	468-2436	Djeffreys@slco.org
X	Exception Requests	Andrea Pullos	468-3770	apullos@slco.org
	Community Council (Send for conditional uses, rezones & ordinance amendments)			
	Public Service Commission	Julia Orchard	530-67143	jorchard@utah.org
	Addressing	Teresa Curtis	468-3255	TCurtis@slco.org
	Engineering Review Specialist	Darlene Jeffreys	468-2436	Djeffreys@slco.org
	Air Quality	Jeannine Maxfield	313-6700	Jmaxfield@slco.org
	Army Corps of Engineers	Hollace Jenks	295-8380 x 14	
	Flood Control	Chris Springer	468-2779	Cspringer@slco.org
	Forest Service - Salt Lake Ranger District	Steve Scheid	801-733-2689	sscheid@fs.fed.us
	Public Works Operations (Send this any time there is construction that affects a road, including all subdivisions.)	Kevyn Smeltzer	562-6490	Ksmeltzer@slco.org
	Parks and Recreation Planner	Angelo Calacino	468-2534	ACalacino@slco.org
	Post Office (for subs and multi family)	Postmaster		
	SLC Water Contracts / Mngmt	Karryn Greenleaf	483-6769	Karryn.Greenleaf@slc.gov
	Salt Lake County Sanitation (all new construction)	Ryan Dyer	562-6419	rdyer@slco.org
	School District (For subs and multi family)			
	Sewer Improvement District (all new construction)			
	Sheriff's Dept: Vice Division	Marcia	743-5892	mhedenstrom@slco.org
	State Department of Natural Resources, Division of Water Rights	Chuck Williamson	538-7240	charleswilliamson@utah.gov
	UDOT	Mark Velasquez	975-4810	mvelasquez@utah.gov
	UTA		743-3882	
	Water District (All New Construction)			
	Public Works / street lights	James Nell	562-6452	inell@slco.org
X	Public Service Commission	Julie Orchard	530-6713	
X	Addressing	Teresa Curtis	468-3255	



79

Salt Lake County Public Works Department
 Planning and Development Services Division
 2001 S. State Street #N-3600 Salt Lake City, UT 84190-4050
 Phone: 801-468-2000 FAX: 801-468-2169
<http://www.pwpds.slco.org/>

Exception Request

Date <u>11/19/09</u> Community Council <u>08</u> Pre Submittal Mtg Date: (if required) <u>✓</u> Pre-Meeting Location: Room N3600	File Number <u>25174</u> Parent File Number <u>25076</u> APN _____ Zone: <u>R18</u>
--	--

Property Address:
3036 South 2000 East, SLC

Requested Use:
Residential 3 Lot Subdivision

Comments:

I am requesting exception from the following :

Sidewalk
 Curb & Gutter
 Street Standards
 Fencing or Piping Ditches
 Other _____

Reason for the request:

Standard Submittal Requirements:
 (Additional information may be required during the review process)
 The items marked with an * can be obtained from the Salt Lake County Recorder's Office 2001 South State St, Room N1600

- Affidavit Form
- * Legal Description of the parcel(s)
- * A current property plat. Outline the subject property with red marker.
- * Mailing Labels List of mailing labels of all property owners within 300' of the outer boundary of the subject property.
- 4 Site Plans Drawing should be on a minimum sheet size of 18" x 24", drawn to a suitable scale (1" = 10, 1" = 20 etc.) and must include the following: North arrow, scale and drawing date. Property lines, with dimensions. Adjoining streets, right-of-ways, easements etc. Location and dimensions of all existing and proposed structures and signs, please list the use and square footage of each structure. Location of structures on adjacent parcels. Location of curb, gutter and sidewalks. Parking calculations. Plant materials list.
- 6 Copies of the existing recorded plat

Property Owner's Name: Ben Olsen
 Mailing Address: P.O. Box 1484 Bountiful, UT 84011
 Daytime Phone #: 801-971-5757 City: Bountiful Zip: 84011
 Fax #: 801-397-5301 e-mail: bolsen@inklynz

Contact / Applicant's Name: Brent Overton
 Mailing Address: 1062 W. Stanley Glen Lane,
 Daytime Phone #: 801-904-2491 City: Taylorville Zip: 84123
 Fax #: _____ e-mail: Overtonrealty@comcast.net

<u>Recommendations:</u>	<u>Approve</u>	<u>Deny</u>	<u>Date</u>
Public Works Engineer	<input type="checkbox"/>	<input type="checkbox"/>	_____
Traffic Engineer	<input type="checkbox"/>	<input type="checkbox"/>	_____
Planning Commission	<input type="checkbox"/>	<input type="checkbox"/>	_____
Mayor's Decision	<input type="checkbox"/>	<input type="checkbox"/>	_____

To facilitate Salt Lake County's land use notice and review process, the undersigned hereby authorize the County to reproduce this application and all documents attached to the application for staff, officials, and the interested public:

 Applicants Signature

11/19/09
 Date

Office Use Only

Application Received by: [Signature]

Fees Due:

\$ 250.00 When filed as part of another application review process independently filed.

\$ 500.00 Independently filed.

Transaction Number 190625 Cashier: [Signature] Date Paid: _____

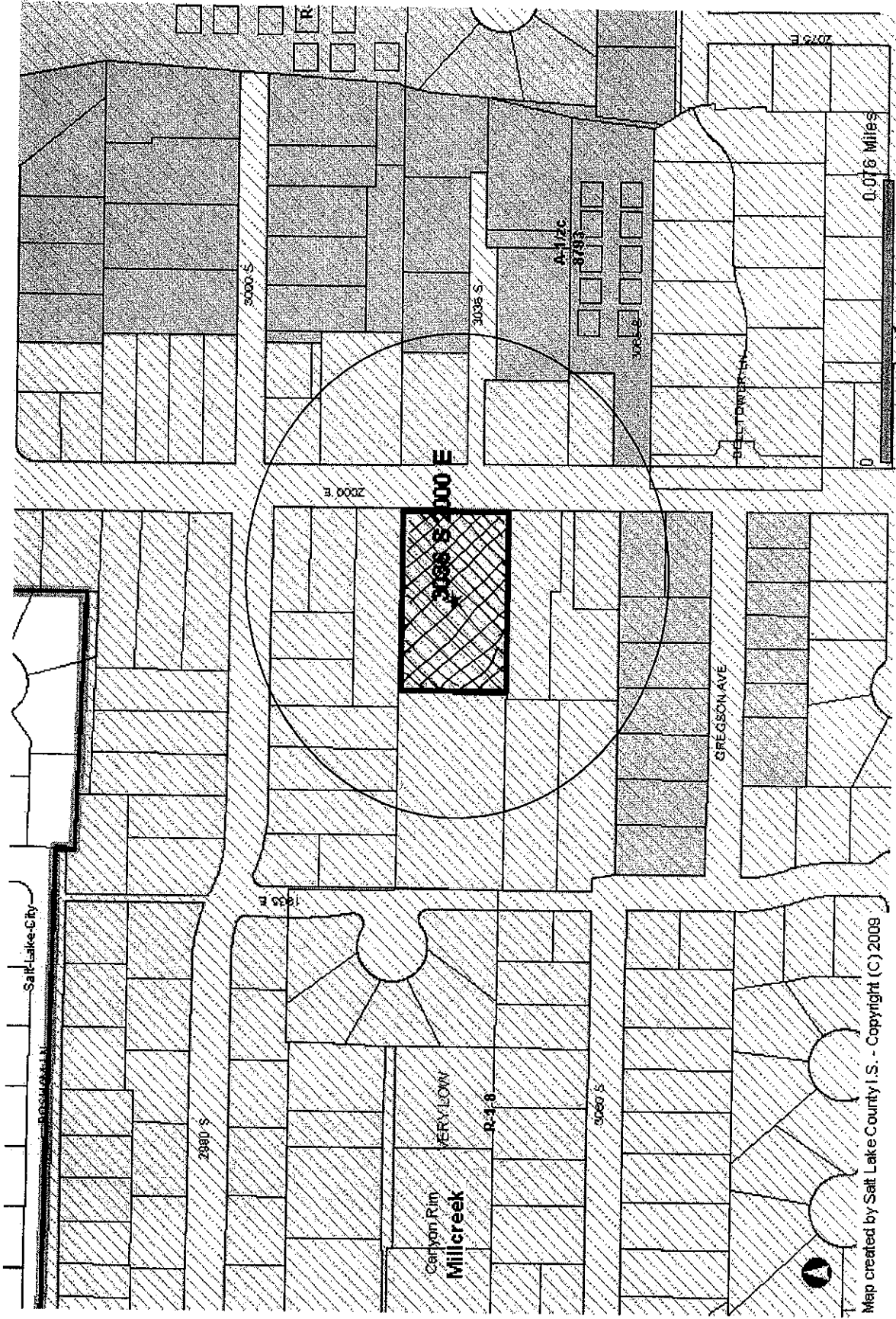

Map created by Salt Lake County I.S. - Copyright (C) 2009

25174 **MISC**
 3036 S 2000 E (2000 E)
 EXCEPT C G SW & STREET...HIGH
 BRENT OVERSON
 Parent Project Number: 25174