

AINSLEY ACRES MINOR SUBDIVISION

A PART OF THE SOUTHEAST QUARTER OF SECTION 20,
T4N, R4E, SALT LAKE BASE AND MERIDIAN,
U. S. SURVEY, MORGAN COUNTY, UTAH.

NOTE: BASED ON THE DRAWING ABOVE, THE SLOPES UNDER 25% WILL BE +/-80%

- S= -26%
- S= -30%
- S= -31%
- S= -34%
- S= -31%
- S= -29%

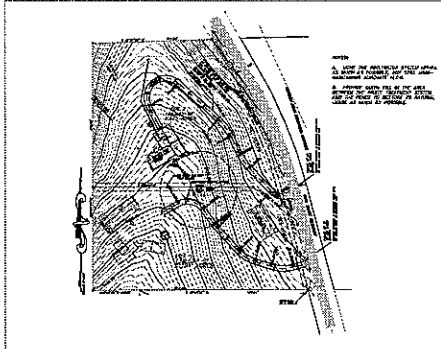

ON-SITE WASTE TREATMENT PLAN
 1365 NORTH 6600 EAST, CROYTON, UT 84018
SCOTT & KAITLIN ESKELSON
 A PART OF THE SEAS & BUCKNER 200 TRACT, S&B
 SALT LAKE BASIN AND NEIGHBOR
 1/2 S. TARRANT, WINDHAM COUNTY, UTAH

- GENERAL NOTES - A**
1. ALL UTILITIES TO BE DELETED AND REINSTALLED AT THE PROPER DEPTH AND LOCATION.
 2. ALL UTILITIES TO BE DELETED AND REINSTALLED AT THE PROPER DEPTH AND LOCATION.
 3. ALL UTILITIES TO BE DELETED AND REINSTALLED AT THE PROPER DEPTH AND LOCATION.
 4. ALL UTILITIES TO BE DELETED AND REINSTALLED AT THE PROPER DEPTH AND LOCATION.
 5. ALL UTILITIES TO BE DELETED AND REINSTALLED AT THE PROPER DEPTH AND LOCATION.
 6. ALL UTILITIES TO BE DELETED AND REINSTALLED AT THE PROPER DEPTH AND LOCATION.
 7. ALL UTILITIES TO BE DELETED AND REINSTALLED AT THE PROPER DEPTH AND LOCATION.
 8. ALL UTILITIES TO BE DELETED AND REINSTALLED AT THE PROPER DEPTH AND LOCATION.
 9. ALL UTILITIES TO BE DELETED AND REINSTALLED AT THE PROPER DEPTH AND LOCATION.
 10. ALL UTILITIES TO BE DELETED AND REINSTALLED AT THE PROPER DEPTH AND LOCATION.
- GENERAL NOTES - B**
1. ALL UTILITIES TO BE DELETED AND REINSTALLED AT THE PROPER DEPTH AND LOCATION.
 2. ALL UTILITIES TO BE DELETED AND REINSTALLED AT THE PROPER DEPTH AND LOCATION.
 3. ALL UTILITIES TO BE DELETED AND REINSTALLED AT THE PROPER DEPTH AND LOCATION.
 4. ALL UTILITIES TO BE DELETED AND REINSTALLED AT THE PROPER DEPTH AND LOCATION.
 5. ALL UTILITIES TO BE DELETED AND REINSTALLED AT THE PROPER DEPTH AND LOCATION.
 6. ALL UTILITIES TO BE DELETED AND REINSTALLED AT THE PROPER DEPTH AND LOCATION.
 7. ALL UTILITIES TO BE DELETED AND REINSTALLED AT THE PROPER DEPTH AND LOCATION.
 8. ALL UTILITIES TO BE DELETED AND REINSTALLED AT THE PROPER DEPTH AND LOCATION.
 9. ALL UTILITIES TO BE DELETED AND REINSTALLED AT THE PROPER DEPTH AND LOCATION.
 10. ALL UTILITIES TO BE DELETED AND REINSTALLED AT THE PROPER DEPTH AND LOCATION.
- GENERAL NOTES - C**
1. ALL UTILITIES TO BE DELETED AND REINSTALLED AT THE PROPER DEPTH AND LOCATION.
 2. ALL UTILITIES TO BE DELETED AND REINSTALLED AT THE PROPER DEPTH AND LOCATION.
 3. ALL UTILITIES TO BE DELETED AND REINSTALLED AT THE PROPER DEPTH AND LOCATION.
 4. ALL UTILITIES TO BE DELETED AND REINSTALLED AT THE PROPER DEPTH AND LOCATION.
 5. ALL UTILITIES TO BE DELETED AND REINSTALLED AT THE PROPER DEPTH AND LOCATION.
 6. ALL UTILITIES TO BE DELETED AND REINSTALLED AT THE PROPER DEPTH AND LOCATION.
 7. ALL UTILITIES TO BE DELETED AND REINSTALLED AT THE PROPER DEPTH AND LOCATION.
 8. ALL UTILITIES TO BE DELETED AND REINSTALLED AT THE PROPER DEPTH AND LOCATION.
 9. ALL UTILITIES TO BE DELETED AND REINSTALLED AT THE PROPER DEPTH AND LOCATION.
 10. ALL UTILITIES TO BE DELETED AND REINSTALLED AT THE PROPER DEPTH AND LOCATION.

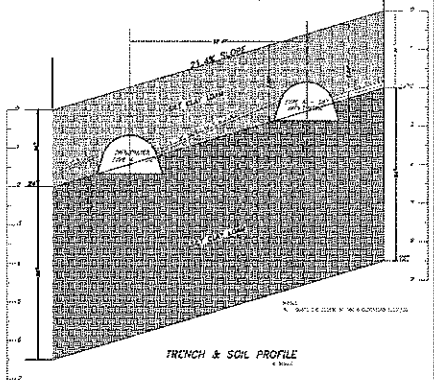

PROFILE OF WASTE TREATMENT FACILITIES

STATION	DESCRIPTION	DEPTH (FEET)	DIAMETER (FEET)	LENGTH (FEET)	CONCRETE (CY)	STEEL (LBS)	PIPE (CY)	VALVE (CY)	MANHOLE (CY)	OTHER
1+00	1750 GALLON SEPTIC TANK	4.0	4.0	10.0	1.0	100	1.0	0.0	0.0	
1+10	1750 GALLON SEPTIC TANK	4.0	4.0	10.0	1.0	100	1.0	0.0	0.0	
1+20	1750 GALLON SEPTIC TANK	4.0	4.0	10.0	1.0	100	1.0	0.0	0.0	
1+30	1750 GALLON SEPTIC TANK	4.0	4.0	10.0	1.0	100	1.0	0.0	0.0	
1+40	1750 GALLON SEPTIC TANK	4.0	4.0	10.0	1.0	100	1.0	0.0	0.0	
1+50	1750 GALLON SEPTIC TANK	4.0	4.0	10.0	1.0	100	1.0	0.0	0.0	

OPERATIONS FOR EASE ACCESS

1. ALL UTILITIES TO BE DELETED AND REINSTALLED AT THE PROPER DEPTH AND LOCATION.

2. ALL UTILITIES TO BE DELETED AND REINSTALLED AT THE PROPER DEPTH AND LOCATION.

3. ALL UTILITIES TO BE DELETED AND REINSTALLED AT THE PROPER DEPTH AND LOCATION.

4. ALL UTILITIES TO BE DELETED AND REINSTALLED AT THE PROPER DEPTH AND LOCATION.

5. ALL UTILITIES TO BE DELETED AND REINSTALLED AT THE PROPER DEPTH AND LOCATION.

6. ALL UTILITIES TO BE DELETED AND REINSTALLED AT THE PROPER DEPTH AND LOCATION.

7. ALL UTILITIES TO BE DELETED AND REINSTALLED AT THE PROPER DEPTH AND LOCATION.

8. ALL UTILITIES TO BE DELETED AND REINSTALLED AT THE PROPER DEPTH AND LOCATION.

9. ALL UTILITIES TO BE DELETED AND REINSTALLED AT THE PROPER DEPTH AND LOCATION.

10. ALL UTILITIES TO BE DELETED AND REINSTALLED AT THE PROPER DEPTH AND LOCATION.

WASTE TREATMENT STATISTICS

1. ALL UTILITIES TO BE DELETED AND REINSTALLED AT THE PROPER DEPTH AND LOCATION.

2. ALL UTILITIES TO BE DELETED AND REINSTALLED AT THE PROPER DEPTH AND LOCATION.

3. ALL UTILITIES TO BE DELETED AND REINSTALLED AT THE PROPER DEPTH AND LOCATION.

4. ALL UTILITIES TO BE DELETED AND REINSTALLED AT THE PROPER DEPTH AND LOCATION.

5. ALL UTILITIES TO BE DELETED AND REINSTALLED AT THE PROPER DEPTH AND LOCATION.

6. ALL UTILITIES TO BE DELETED AND REINSTALLED AT THE PROPER DEPTH AND LOCATION.

7. ALL UTILITIES TO BE DELETED AND REINSTALLED AT THE PROPER DEPTH AND LOCATION.

8. ALL UTILITIES TO BE DELETED AND REINSTALLED AT THE PROPER DEPTH AND LOCATION.

9. ALL UTILITIES TO BE DELETED AND REINSTALLED AT THE PROPER DEPTH AND LOCATION.

10. ALL UTILITIES TO BE DELETED AND REINSTALLED AT THE PROPER DEPTH AND LOCATION.

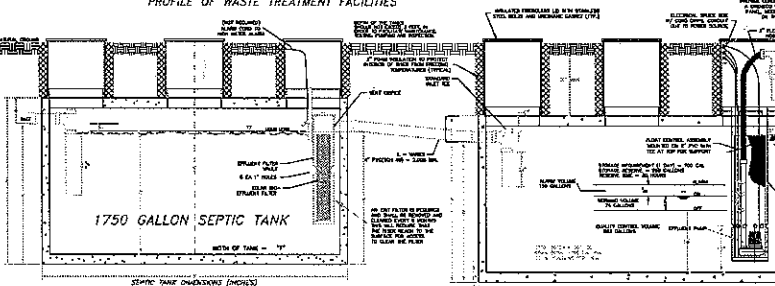

ENLARGED DESIGN DATA

1. ALL UTILITIES TO BE DELETED AND REINSTALLED AT THE PROPER DEPTH AND LOCATION.

2. ALL UTILITIES TO BE DELETED AND REINSTALLED AT THE PROPER DEPTH AND LOCATION.

3. ALL UTILITIES TO BE DELETED AND REINSTALLED AT THE PROPER DEPTH AND LOCATION.

4. ALL UTILITIES TO BE DELETED AND REINSTALLED AT THE PROPER DEPTH AND LOCATION.

5. ALL UTILITIES TO BE DELETED AND REINSTALLED AT THE PROPER DEPTH AND LOCATION.

6. ALL UTILITIES TO BE DELETED AND REINSTALLED AT THE PROPER DEPTH AND LOCATION.

7. ALL UTILITIES TO BE DELETED AND REINSTALLED AT THE PROPER DEPTH AND LOCATION.

8. ALL UTILITIES TO BE DELETED AND REINSTALLED AT THE PROPER DEPTH AND LOCATION.

9. ALL UTILITIES TO BE DELETED AND REINSTALLED AT THE PROPER DEPTH AND LOCATION.

10. ALL UTILITIES TO BE DELETED AND REINSTALLED AT THE PROPER DEPTH AND LOCATION.

MOUNTAIN ENGINEERING

SCOTT & KAITLIN ESKELSON

1750 N. 6600 E. CROYTON, UT 84018

PHONE: 435-734-1234 FAX: 435-734-1234

WWW.MOUNTAINENGINEERING.COM